

Encombrement de la gamme d'enrouleurs EF+ / EF+ Range dimensions (mm)

Rev A : inclu long palier / bearing added
RevB : 684-->770 / 777 --> 770
RevC : J1, J2, J3, J4 + modification of G

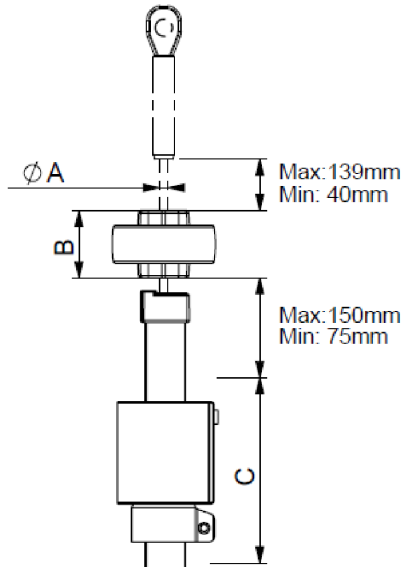

*D: extrémité du tube télescopique/
Fitted-in length of the inner foil section

** latte désormais non disponibles /
No more available

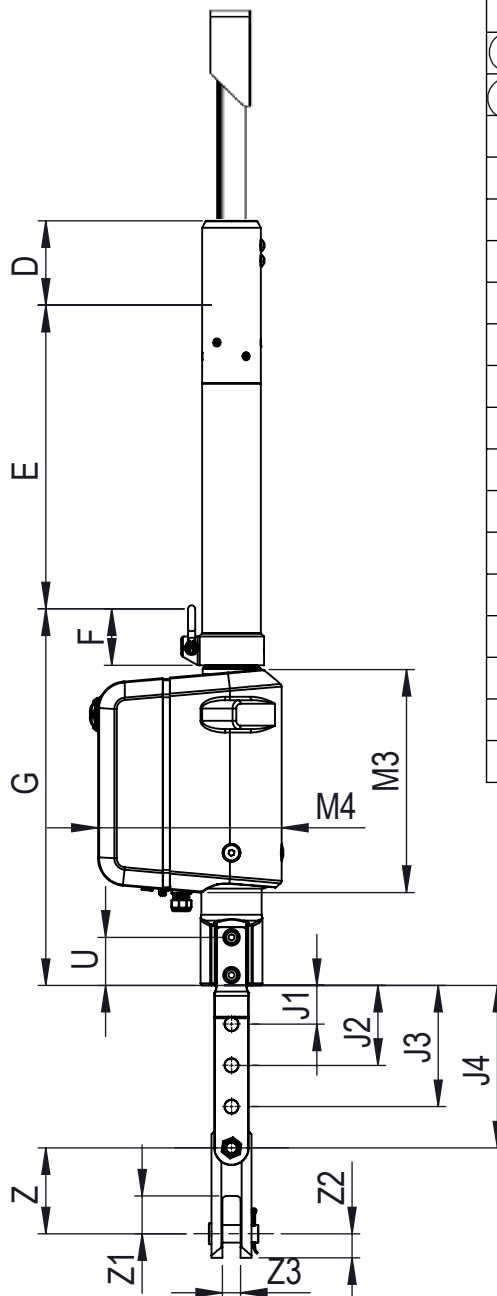
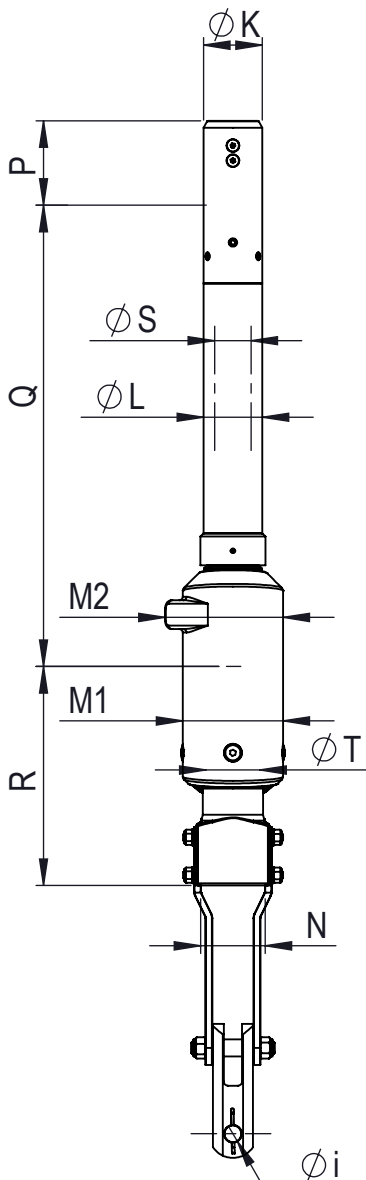

MODELE enrouleur. élec élec. furler	EF+ 550 SX 47	EF+ 600 SX 53
Ref Profil / Emer. Section / Swivel	SX 47 / CX 47	SX53 / C 600
A = Ø d'étai / forestay max. (*ridoir / turnbuckle)	12 mm* 14 mm*	22 mm*
B	53	53
C	226	235
D*	103	123
(A) E	263	486
F	82	82
(B) G	548	548
(C) J1	56	56
J2	116	116
J3	176	176
J4**	236	236
M4	267	267
ØK	72	85
ØL	72	86
M1	146	146
M2	172	172
M3	324	324
N	93	93
P	103	123
Q	435	671
R	265	318
ØS	53	53
T	78	78
U	70	70

axe / pin Øi	Z	Z1	Z2	Z3
19	94	42	29	20.5
22	105	36.5	32.5	22.5
25	125	55	35	26.5
28	140	50	39	29
32	165	75	42	33